

TO: James L. App, City Manager
FROM: Robert A. Lata, Community Development Director
SUBJECT: PD 02-008 – Jiffy Lube for Annexation into the Landscape and Lighting Maintenance District (Petrelli)
DATE: March 1, 2005

Needs: That the City Council consider the annexation of the new Jiffy Lube store (PD 02-008) into the Landscape and Lighting Maintenance District.

Facts: 1. The applicants have signed a petition and voted in favor of annexation into the Landscape and Lighting District.

**Analysis
and**

Conclusion: Jiffy Lube, PD 02-008, was approved by the Planning Commission on January 14, 2003, with the condition that the property be annexed into the Landscape and Lighting District.

Policy

Reference: California Government Code Section 66462 (“Subdivision Map Act”)
Paso Robles Municipal Code Section 22.16.160

Fiscal

Impact: None.

Options: That the City Council accept the signed petition and ballot to annex into Landscape and Lighting District No. 1, Sub Area 96, by taking the following action:

- a. Adopt Resolution No. 05-xx annexing amended PD 02-008 into the Landscape and Lighting District.
- b. Amend, modify or reject the above option.

Attachments: (2)

- 1) Vicinity Map
- 2) Resolution L & L

RECORDING REQUESTED BY AND
WHEN RECORDED RETURN TO:

The City of El Paso de Robles
Public Works Department
1000 Spring Street
Paso Robles, CA 93446

Attn.: Ditas Esperanza

FOR RECORDERS USE ONLY

RESOLUTION NO. 05-xx

A RESOLUTION OF THE CITY COUNCIL OF THE CITY OF PASO ROBLES
ANNEXING PD 02-008 AS PART OF SUBAREA 96 TO THE
“PASO ROBLES LANDSCAPE AND LIGHTING DISTRICT NO. 1”
(STREETS AND HIGHWAYS CODE SECTIONS 22500, ET SEQ.)

WHEREAS, the owner of the real property described in Exhibit ‘A’ has petitioned for annex PD 02-008 into the Paso Robles Landscape and Lighting District No. 1 (“District”).

NOW, THEREFORE, BE IT RESOLVED, DETERMINED AND ORDERED as follows:

SECTION 1. That the City Council of the City of Paso Robles does hereby declare that the real property located in the City of Paso Robles, County of San Luis Obispo, as more particularly described in Exhibit ‘A’ hereto, is hereby annexed into the District and that all landscape and lighting improvements required as conditions of approval of PD 02-008 be installed by the developer.

SECTION 2. That the City Council of the City of Paso Robles does hereby declare that the current owner of the real property, according to the Petition for Formation of the District, is Phase II Realty, LLC.

SECTION 3. That the City Council for the City of Paso Robles does hereby declare that the assessment for PD 02-008 shall begin with Fiscal Year 2006-2007.

SECTION 4. That the City Council for the City of Paso Robles does hereby declare that the area annexed shall be designated Paso Robles Landscape and Lighting District No. 1, as part of Sub-Area 96.

PASSED AND ADOPTED by the City Council of the City of Paso Robles this 1st day of March 2005 by the following vote:

AYES:
NOES:
ABSTAIN:
ABSENT:

Frank R. Mecham, Mayor

ATTEST:

Sharilyn M. Ryan, Deputy City Clerk

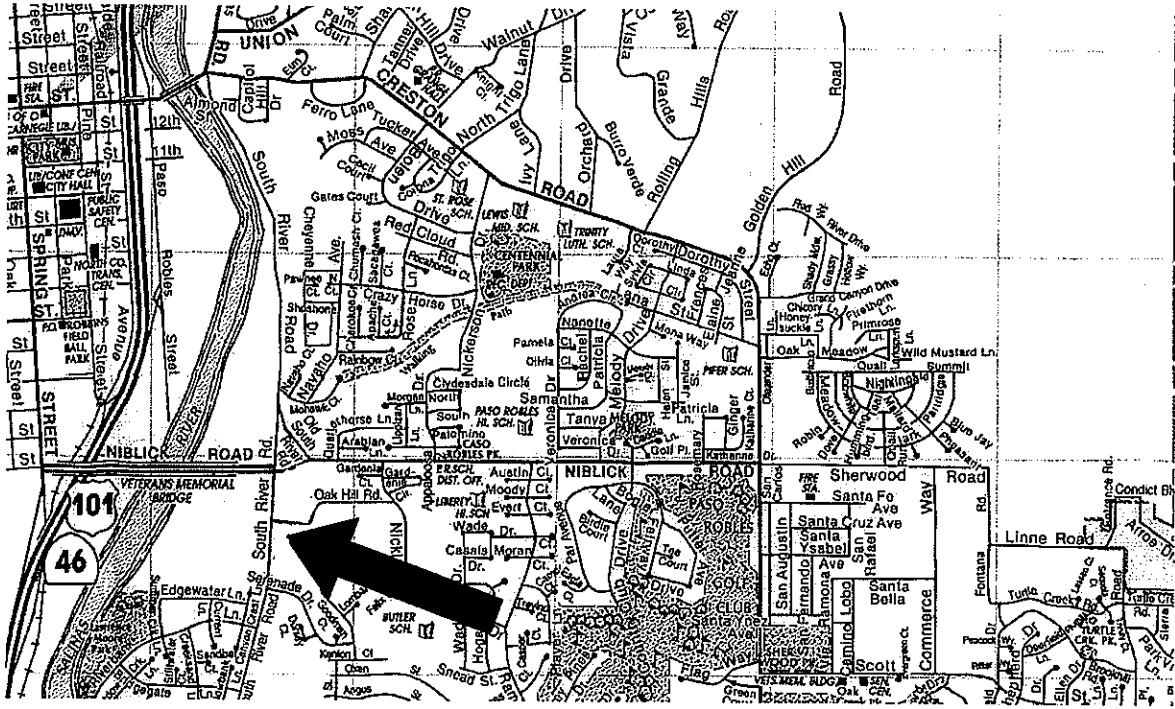

VICINITY MAP ~ PD 02-008
JIFFY LUBE (Petrelli)

Exhibit "A"

LEGAL DESCRIPTION

Real property in the City of Paso Robles, County of San Luis Obispo, State of California, described as follows:

PARCEL 8 OF PARCEL MAP NO. PR-91-095 IN THE CITY OF PASO ROBLES, COUNTY OF SAN LUIS OBISPO, STATE OF CALIFORNIA, ACCORDING TO MAP RECORDED OCTOBER 18, 1993 IN BOOK 50, PAGE 45 OF PARCEL MAPS, AND CERTIFICATE OF CORRECTION RECORDED OCTOBER 6, 1994 AS INSTRUMENT NO. 1994-058253 OF OFFICIAL RECORDS IN THE OFFICE OF THE COUNTY RECORDER OF SAID COUNTY.

TOGETHER WITH THE WESTERLY HALF OF THAT PORTION OF VACATED OLD SOUTH RIVER ROAD LYING ADJACENT TO THE EASTERLY LINE OF PARCEL 8 THAT WOULD ATTACH BY OPERATION OF LAW, AS VACATED BY RESOLUTION RECORDED MARCH 17, 2003 AS DOCUMENT NO. 2003026725 OF OFFICIAL RECORDS.

EXCEPTING THEREFROM 1/2 OF ALL MINERALS, COALS, OILS, PETROLEUM, GAS AND KINDRED SUBSTANCES UNDER AND IN SAID LAND BUT WITHOUT HOWEVER, ANY RIGHT TO USE THE SURFACE AND THAT PORTION OF THE SUBSURFACE LYING ABOVE A DEPTH OF 500 FEET MEASURED VERTICALLY FROM THE SURFACE OF SAID LAND FOR THE PURPOSE OF EXPLORING FOR, DEVELOPING, EXTRACTING OR REMOVING SAID MINERALS OR SUBSTANCES FROM SAID LAND AS RESERVED IN DEED RECORDED FEBRUARY 11, 1976 IN BOOK 1878, PAGE 163 OF OFFICIAL RECORDS.

APN: 009-814-023